

220-240V 50 1~**GENERAL DATA**

Application: MBP
Refrigerant: R290
Evaporating Temperature Range: -20°C to 10°C
Compressor Cooling: Fan
Fan air flow: 520 m³/h
Type: Hermetic reciprocating
Technology Type: On-Off
Expansion Device: Capillary Tube or Expansion Valve
Packing Quantity: Single - 1 pc
Displacement: 20.4 cm³
Horse power: 1 hp

Approvals:   

MECHANICAL DATA

Bore: 36.99 mm
Stroke: 19.03 mm
Oil Charge: 450ml +/-15ml
Free Internal Volume: 3.3 cm³
Maximum Recommended Refrigerant Charge: 150 g
Oil Type Configuration: Polyolester
Oil Type Viscosity: ISO22
Compressor pressurization: Without dry air charge
Weight: 16.6 kg

ELECTRICAL DATA

Motor Type: CSIR
Starting Torque: HST
Voltage working range at 50 Hz: 198-254 V
Maximum Motor Temperature: 130 °C
Start Winding Resistance: 9 Ω (± 10%) at 25°C
Run Winding Resistance: 2.3 Ω (± 10%) at 25°C
Locked Rotor Amperage (LRA): 30 A

MOUNTING ACCESSORIES

	Description	Code
Anchorage:	no	-
Grommets:	yes	2221004
Sleeves:	yes	2222016
Washer:	no	-
Pin:	no	-
Clip:	no	-
Rotolock valve:	no	-
Cover:	yes	2075282
Terminal Board:	yes	1027060
Overload Protector Bracket:	yes	2075299
Capacitor Bracket:	yes	2255007

ELECTRICAL COMPONENTS

	Component type	Description	Code
Starting Device:	Current relay	MTRPH-0019-65	2334138
Motor Protection:	External 3/4"	T0558/G6	2319134
Start Capacitor:		53-64 MFD 330V	2252366

EXTERNAL CHARACTERISTICS

Base Plate: Universal
Tray Holder: No
Height: 220 mm

	Internal Diameter (mm)	Material	Shape
Suction Connector	9.6	Copper	Vertical
Discharge Connector	6.42	Copper	Vertical
Process Connector	6.42	Copper	Vertical



RATED POINT DATA

Cooling Capacity (W)	Power Consumption (W)	Current Consumption (A)	Gas Flow Rate (kg/h)	Efficiency (W/W)
±5%	±5%	±5%	±5%	±7%
2 577	1 068	6.37	29.30	2.41

Test condition: ASHRAE, Fan, Return Gas 35°C, Subcooling 8.3K, Evaporating: 7.2°C, Condensing: 54°C, Ambient: 35°C

PERFORMANCE CURVE DATA**220V 50Hz**

Condensing Temperature (°C)	Evaporating Temperature (°C)	Cooling Capacity (W)	Power Consumption (W)	Current Consumption (A)	Gas Flow Rate (kg/h)	Efficiency (W/W)
		±5%	±5%	±5%	±5%	±7%
35°C	10	3 562	812	5.50	35.76	4.39
	5	3 050	799	5.46	29.24	3.82
	0	2 577	780	5.40	25.18	3.30
	-5	2 145	754	5.31	21.96	2.84
	-10	1 756	719	5.21	17.93	2.44
	-15	1 414	673	5.08	11.47	2.10
	-20	1 119	614	4.93	0.95	1.82

Condensing Temperature (°C)	Evaporating Temperature (°C)	Cooling Capacity (W)	Power Consumption (W)	Current Consumption (A)	Gas Flow Rate (kg/h)	Efficiency (W/W)
		±5%	±5%	±5%	±5%	±7%
45°C	10	3 190	955	5.98	34.89	3.34
	5	2 701	923	5.86	27.96	2.93
	0	2 255	885	5.73	23.69	2.55
	-5	1 854	841	5.58	20.46	2.21
	-10	1 500	787	5.41	16.64	1.91
	-15	1 196	723	5.23	10.57	1.65
	-20	945	646	5.02	0.65	1.46

Condensing Temperature (°C)	Evaporating Temperature (°C)	Cooling Capacity (W)	Power Consumption (W)	Current Consumption (A)	Gas Flow Rate (kg/h)	Efficiency (W/W)
		±5%	±5%	±5%	±5%	±7%
55°C	10	2 804	1 113	6.55	33.65	2.52
	5	2 342	1 059	6.33	26.40	2.21
	0	1 927	1 000	6.10	22.01	1.93
	-5	1 560	934	5.86	18.87	1.67
	-10	1 245	859	5.62	15.32	1.45

Test condition: ASHRAE, Fan, Return Gas 35°C, Subcooling 8.3K, Ambient: 35°C

ASSEMBLY INSTRUCTION

WIRING DIAGRAM

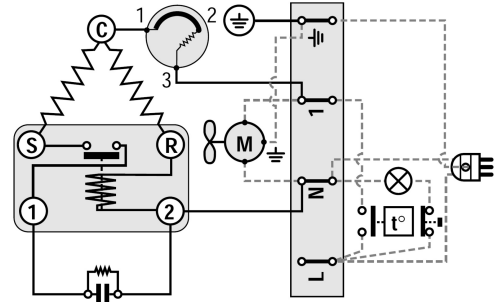
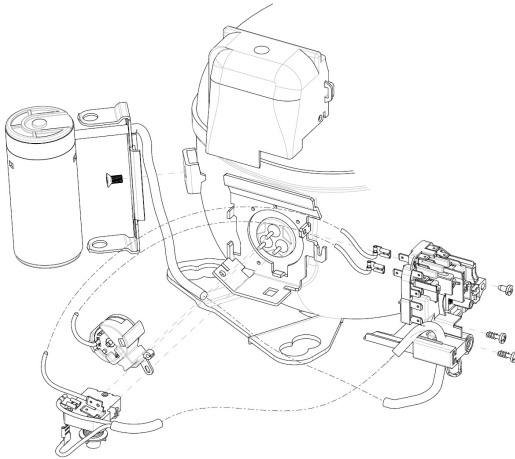

OPERATING ENVELOPE

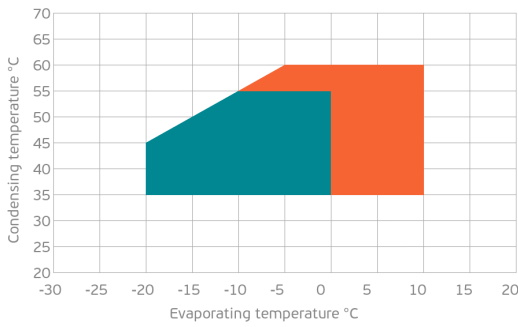

- Operating Condition
- Transient Condition
- Superheating

NOTE: usage of compressors outside of intended working range cannot make use of the warranty, or should be consulted with Technical support.

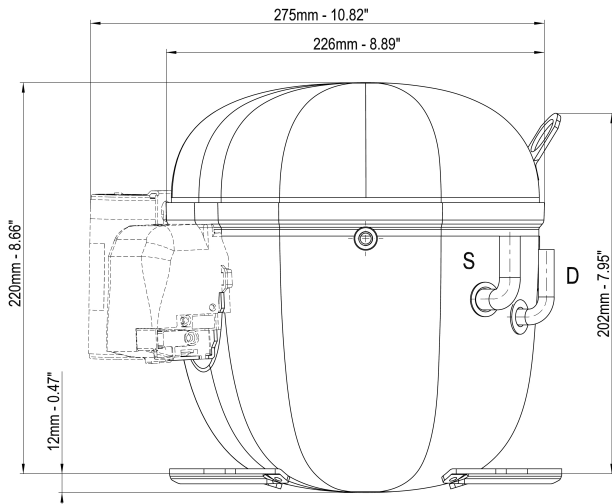

	∅ mm	∅ in	Material
S - Suction	9.60	0.37	Cu
P - Process	6.42	0.25	Cu
D - Discharge	6.42	0.25	Cu

